

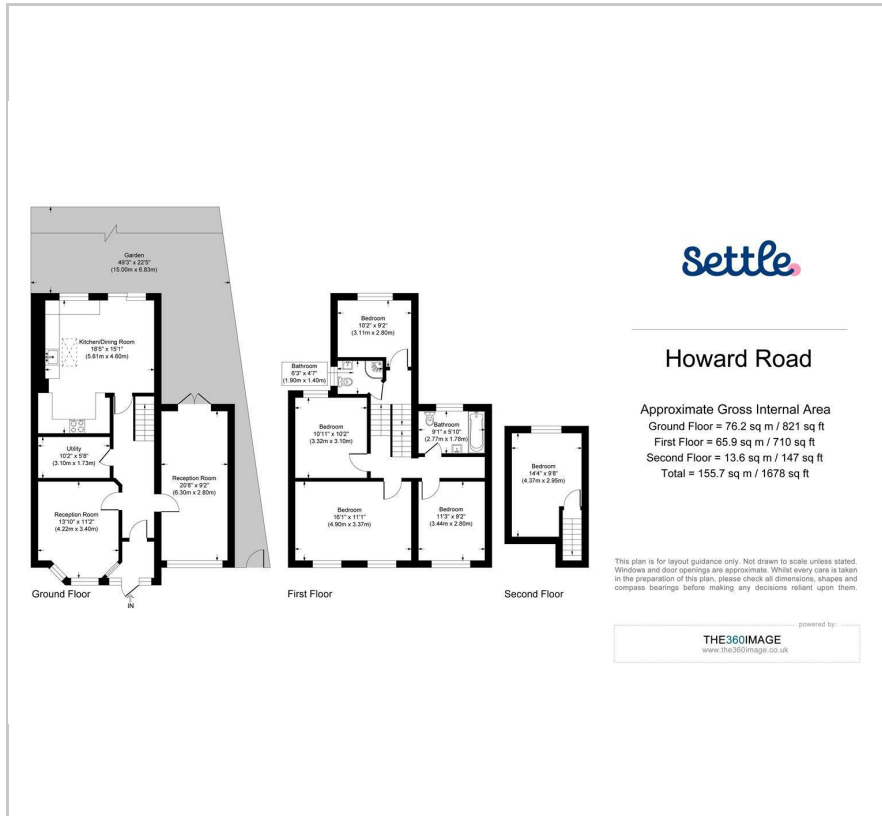

Howard Road
, London, E17 4SG
£3,600 Per month

🛏️ 5 🚿 2 🛋️ 2 ☰ D

Floor Plan



Area Map



Energy Efficiency Graph

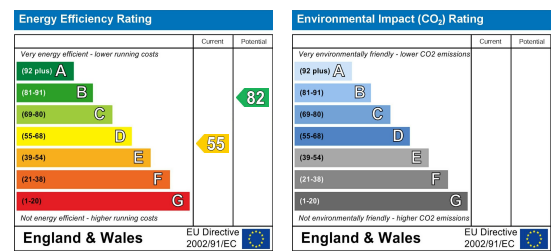

Viewing

Please contact our Settle Office on 0208 124 2522 if you wish to arrange a viewing appointment for this property or require further information.

- Five Bedroom Family Home
- Spacious Kitchn/Diner
- Two Bathrooms
- Furnished
- EPC Rating D
- Split on Three Floors
- Separate Living Area
- Available Early August
- Council Tax Band D
- 1678 Sq Ft - 155.7 Sq M



An attractive double-fronted five-bedroom home offering spacious and versatile accommodation.

The ground floor features two generous reception rooms, providing flexible living and entertaining space. At the heart of the home is a fully fitted kitchen diner, perfect for family meals and social gatherings, complemented by a convenient utility room located between the kitchen and living areas for added practicality.

On the first floor, there are four well-proportioned bedrooms and two family bathrooms, offering comfortable accommodation for growing families. A further staircase leads to the second floor, where you will find the fifth bedroom, creating an ideal principal suite, guest room or home office.

Externally, the property benefits from a private rear garden, providing a wonderful space for outdoor relaxation, entertaining, and family activities. Side access adds further convenience, offering easy access to the garden without passing through the house.

Note: Due to Property Licensing restrictions with Waltham Forest Council we can only accept a maximum of two households for this property.

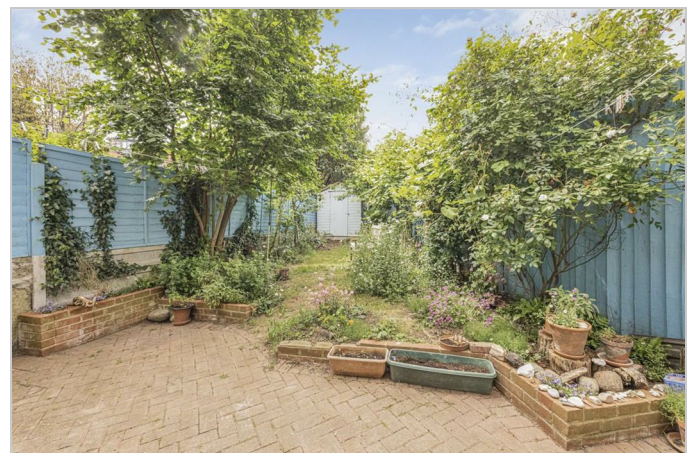

These particulars, whilst believed to be accurate are set out as a general outline only for guidance and do not constitute any part of an offer or contract. Intending purchasers should not rely on them as statements of representation of fact, but must satisfy themselves by inspection or otherwise as to their accuracy. No person in this firm's employment has the authority to make or give any representation or warranty in respect of the property.